

International Myotonic Dystrophy Consortium - 8
NOV 30 - DEC 3 | CLEARWATER BEACH FLORIDA



IDMC-8



Table of Contents

Welcome	3
Committees	4
Congress General Information	5
Social Activities	6
Sponsors	7
Map of Hotel	8
Scientific Program	9
Oral Presentations	18
Posters	82
Attendee Contact Information	165
Notes	188

Welcome

Welcome to the 8th International Myotonic Dystrophy Consortium (IDMC-8) Meeting. The IDMC is an informal group of clinicians and research scientists who have a common interest in understanding the molecular events which result in the neuromuscular disease myotonic dystrophy (dystrophia myotonica, DM) and using this information to generate effective treatment strategies for this disease. The IDMC-8 meeting is not only designed to provide a forum for scientific presentations and discussions on the latest results in DM pathogenesis and therapy development but also to promote interactions between clinicians, basic scientists, patients and their families.

This is an exciting time in DM research. We hope you enjoy IDMC-8!

Tetsuo Ashizawa, M.D. and Maurice Swanson, Ph.D.
Co-Chairs, IDMC-8 Organizing Committee

Committees

Organizing Committee

Co-Chairs

Tetsuo Ashizawa, University of Florida, Gainesville, USA

Maurice Swanson, University of Florida, Gainesville, USA

Local Committee

Laura Ranum, University of Florida, Gainesville, USA

S.H. Subramony, University of Florida, Gainesville, USA

Basic Science Subcommittee

Geneviève Gourdon, Hôpital Necker-Enfants Malades, France

Shoichi Ishiura, Riken, Japan

Ralf Krahe, UTMDACC, USA

Darren Monckton, University of Glasgow, UK

Christopher Pearson, Hospital for Sick Children, Canada

Jack Puymirat, CHU Laval Research Center, Canada

Charles Thornton, University of Rochester, USA

Be Wieringa, University of Nijmegen, The Netherlands

Clinical Science Subcommittee

John Day, University of Minnesota, USA

Bruno Eymard, Hôpital Pitié-Salpêtrière, France

Tiemo Grimm, University of Würzburg, Germany

Giovanni Meola, University of Milan, Italy

Richard Moxley, University of Rochester, USA

Mark Rogers, University of Wales, England

Benedikt Schoser, University of Munich, Germany

Bjarne Udd, University of Helsinki and Tampere University Hospital, Finland

Conference Organizer

Catherine Gentilman, CMP, CGMP

*University of Florida, Department of Conferences
Gainesville, FL, USA*

Tel: (352) 294-0846

Email: cgentilman@dce.ufl.edu

Congress General Information

Meeting Venue:

Sheraton Sand Key Resort
1160 Gulf Blvd.
Clearwater Beach, FL 33767-2799, USA
Tel: (727) 595-1611
<http://www.sheratonsandkey.com>

Registration:

The Registration desk is located outside of the meeting ballroom. The Registration desk will open Wednesday, November 30, 2011 at 15:00. The desk will remain open for the duration of the conference.

Oral Presentations:

Each speaker will have a 10 minute period for slide presentations with an additional five minutes for discussion. The program is packed and the session chairs will stick rigorously to the schedule. Speakers will have an opportunity to review their presentations in the speaker ready room.

Posters:

Posters should be attached on their boards on Thursday, December 1, 2011 before 10:00 and removed on Friday, December 2, 2011 by 18:00.

Meal Functions:

Breakfast, lunch, receptions and a closing dinner are included in the conference. Please refer to the agenda for the various locations.

Language:

The official language of the IDMC-8 is English.

Satellite Meetings:

Wednesday, November 30, 2011, 8:00 AM-3:00 PM

Outcome Measures for Myotonic Dystrophy

Organizer: Cynthia Gagnon

Sunday, December 4, 2011

Myotonic Dystrophy Foundation Patient Conference

Social Activities

Wednesday, November 30, 2011

Welcome Reception by the Gulf of Mexico

Sheraton Sand Key Resort Near the Turtle Bar

5:00 PM

Come join us for our welcome reception and enjoy the sunset.



Friday, December 2, 2011

Reception at the Salvador Dali Museum

Salvador Dali Museum

6:30-10:00 PM

Come join us for a wonderful reception at the Dali Museum. They have the world's most comprehensive collection of works by Salvador Dali. Transportation to and from the reception will be provided.

<http://www.salvadoralimuseum.org>

st. petersburg, florida



Saturday, December 3, 2011

Farewell Dinner on the Beach

Sheraton Sand Key Resort

6:30-10:00 PM

Come join us for our farewell dinner on the beach.

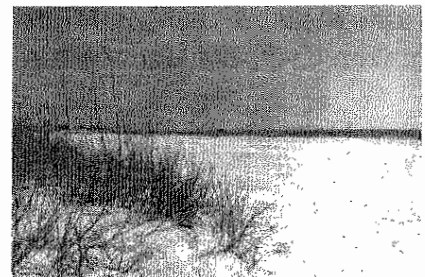

Sponsors

Association Française contre les Myopathies (AFM)

BioRad

University of Florida Center for NeuroGenetics

Genzyme

Isis Pharmaceuticals

Marigold Foundation

McKnight Brain Institute

Muscular Dystrophy Association (MDA)

Myotonic Dystrophy Foundation (MDF)

Myotonic Dystrophy Support Group (MDSG)

National Institutes of Health (NINDS, NIAMS, ORDR)

PTC Therapeutics

Shea-Robert Sheahan Trust

University of Florida Genetics Institute

Map of Hotel

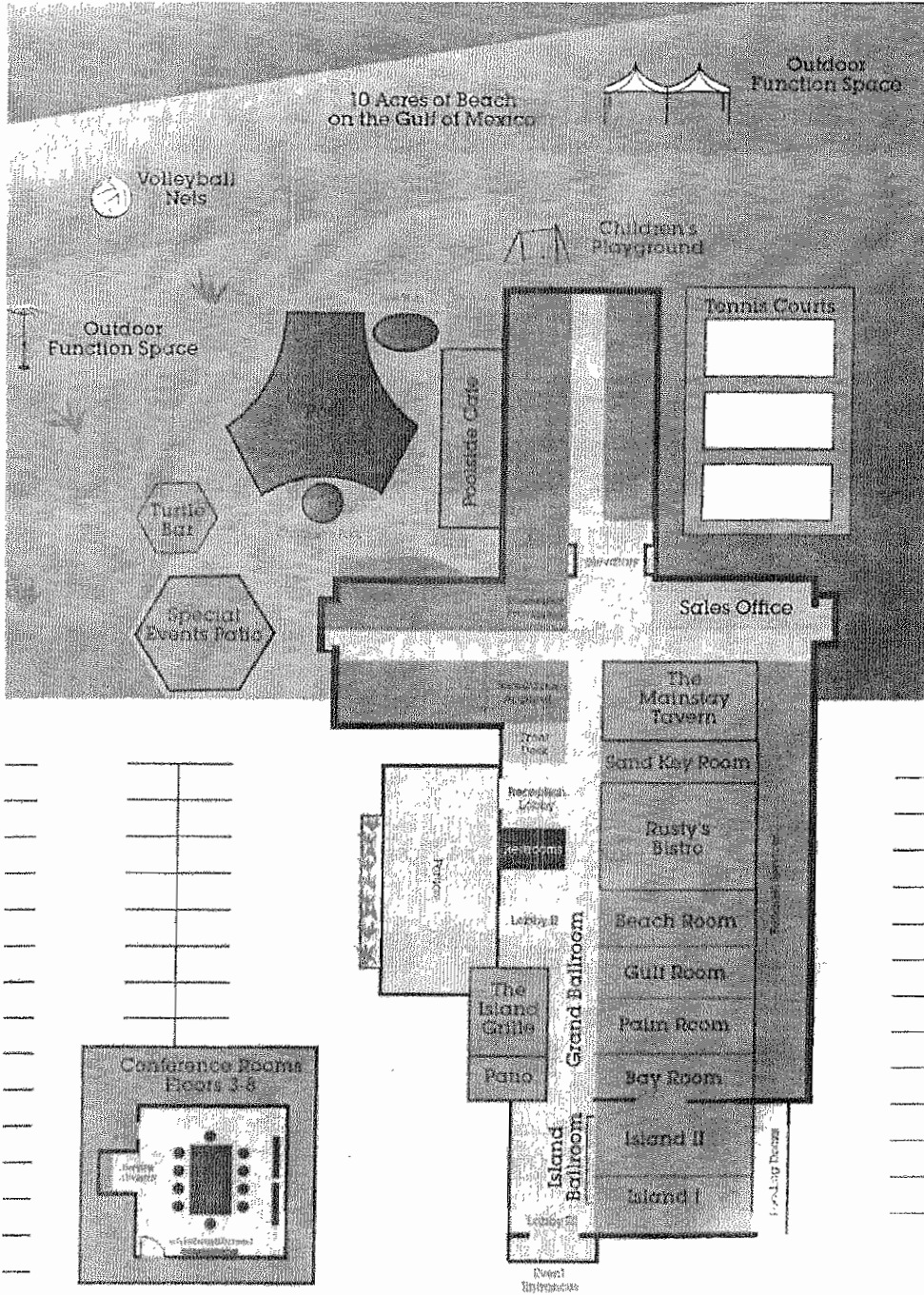

IDMC-8 Scientific Program

Wednesday, November 30, 2011

3:00 PM/15:00	Registration and Check-In	Prefunction Area of Ballroom
5:00 PM/17:00	Welcome Reception	Sheraton Sand Key Resort (outside near the Turtle Bar)
7:00 - 9:30 PM	Session 1 - Opening Ceremony & Special Lectures	Island Ballroom
	S1.1 Welcome addresses and meeting information Tee Ashizawa and Maurice Swanson (Gainesville, USA)	
	Keynote Lectures <i>Chairs: Tee Ashizawa (Gainesville, USA)</i> <i>Thomas Cooper (Houston, USA)</i>	
7:30 - 8:15 PM	S1.2 Myotonic Dystrophy: The Disease Richard Moxley (Rochester, USA)	
8:30 - 9:15 PM	S1.3 The Transcriptome in Myotonic Dystrophy Christopher Burge (Boston, USA)	

Thursday, December 1, 2011

7:00	Registration/Information Desk Open	Prefunction Area of Ballroom
7:00-8:00	Breakfast	Grand Ballroom
8:00-12:00 PM	Session 2 - Disease Mechanisms I <i>Chairs: Ralf Krahe (Houston, USA)</i> <i>Shoichi Ishiura (Riken, Japan)</i>	Island Ballroom
8:00-8:30	S2.1 Overview Lecture: DNA Instability Meets RNA Toxicity Christopher Pearson (Toronto, Canada)	
Invited Talks from Abstracts (10 min talk, 5 min question period)		
8:30-8:45	S2.01 Intergenerational Transmission of the Myotonic Dystrophy Type 1 Mutation: Improved Risk Assessments for Congenital Disease F Morales, M Vásquez, P Cuenca, D Campos, C Santamaría, G del Valle, R Brian, M Sittenfeld, T Ashizawa & DG Monckton	
8:45-9:00	S2.02 Structure of Slipped-DNA Junctions Determine Correct or Mutagenic Repair of CAG/CTG Repeats MM. Slean, K Reddy, B Wu, KN Edamura, M Kekis, F Nelissen, R Aspers, M Tessari, OD. Schärer, SS. Wijmenga, CE. Pearson	
9:00-9:15	S2.03 MicroRNA Misregulated in DM1 Targets CUGBP1 E Querido, A Fournier, C Ménard, J Puymirat, P Chartrand	

IDMC-8 Scientific Program Continued

9:15-9:30	S2.04 Next Generation Sequencing Reveals miRNome Alterations in a DM1 <i>Drosophila</i> Model that are Conserved in Humans <u>JM Fernandez-Costa</u> , A Garcia-Lopez, A Felipo, A Bargiela, MB Llamusi, S Zuñiga, J Terol, V Fernandez, M Mata, M Perez-Alonso, AL deMunain and R Artero	
9:30-9:45	S2.05 The Processing of miR-1 is Altered in Myotonic Dystrophy <u>F Freyermuth</u> , F Rau, C Fugier, JP Villemin, MC Fischer, B Jost, D Dembele, G Gourdon, A Nicole, D Duboc, K Wahbi, JW Day, H Fujimura, MP Takahash, D Auboeuf, N Dreumont, D Furling, N Charlet-Berguerand	
9:45-10:00	S2.06 Correction of Processing and Decay of the Mutant DMPK and ZNF9 Transcripts in Myotonic Dystrophies Type 1 and Type 2 <u>K Jones</u> , B Jin, P Iakova, Bugiardini E, C Schneider-Gold, G Meola, NA Timchenko, LT Timchenko	
10:00-10:30	Coffee Break	Grand Ballroom
10:30-10:45	S2.07 CELF1-Mediated mRNA Decay Regulates Protein Secretion and Myogenesis and may be Impaired in Myotonic Dystrophy <u>AM Dickson</u> , CM López, JE Lee, T Nguyen, J Wilusz, CJ Wilusz	
10:45-11:00	S2.08 Evidence that Double Stranded RNA Activates the Innate Immune Response and Interferon Signalling in Myotonic Dystrophy <u>JD. Rhodes</u> , M Lott, SL. Russell, V Moulton, J Sanderson, M Wormstone, D Broadway	
11:00-11:15	S2.09 Mutant (CCUG)_{DM2} RNA Activates Cytoplasmic Stress Signaling Pathways in Myotonic Dystrophy Type 2 (DM2) Y Deng, KA. Baggerly, M Sirito, LL. Bachinski, B Schoser, B Udd, <u>R Krahe</u>	
11:15-11:30	S2.10 Fox Proteins Chase MBNL1 from CCUG Aggregates: An Explanation to the Lesser Severity of DM2? <u>C Sellier</u> , C Fugier, C Hammer, B Udd, J Puymirat, G Bassez, B Schoser, R Krahe, A Bergmann, D Furling, N Charlet-Berguerand	
11:30-11:45	S2.11 Misregulation of Cardiac MEF2 Gene Program in Myotonic Dystrophy <u>A Kalsotra</u> , R Singh, C Creighton, T Cooper	
11:45-12:00 PM	S2.12 Misregulated Alternative Splicing of CaV1.1 in Myotonic Dystrophy: Abnormal Calcium Channel Gating with Potential for Aggravation of Myopathy <u>ZZ Tang</u> , V Yarotsky, L Wei, K Sobczak, M Nakamori, K Eichinger, RT Moxley, RT Dirksen, CA Thornton	
12:00-12:15	S2.13 The RNA-binding protein Staufen1 controls myogenic differentiation <u>FX Laurent</u> , A Sureau, AF Klein, F Trouslard, D Furling, J Marie	

IDMC-8 Scientific Program Continued

12:00-2:00	<p>Lunch and Poster Viewing with Presenters</p> <p>Disease Mechanisms P1-P28 <i>Chairs: Thomas Cooper (Houston, USA)</i> <i>Sita Reddy (Los Angeles, USA)</i></p> <p>Cell and Animal Models Posters P29-P36 <i>Chairs: Denis Furling (Paris, France)</i> <i>Derick Wansink (Nijmegen, The Netherlands)</i></p>	Grand Ballroom
2:00-4:15	<p>Session 3 – Disease Mechanisms II <i>Chairs: David Brook (Nottingham, UK)</i> <i>Lubov Timchenko (Houston, USA)</i></p>	Island Ballroom
Invited Talks from Abstracts (10 min talk, 5 min question period)		
2:00-2:15	<p>S3.14 Repeat Associated Non-AUG (RAN) Translation: Implications for Myotonic Dystrophy <u>T Zu</u>, B Gibbens NS Doty, MS Swanson, LPW Ranum</p>	
2:15-2:30	<p>S3.15 Muscleblind Proteins Repress Aberrant Protein Expression Derived from Expanded Repeats <u>Y Kino</u>, C Washizu, M Kurowasa, Y Oma, S Ishiura, N Nukina</p>	
2:30-2:45	<p>S3.16 Non-AUG Initiated Translation Drives Inclusion Formation in FXTAS <u>PK Todd</u>, S Oh, A Krans, M Frazer, AJ Renoux, KM Scaglione, V Basur, K Elinitoba-Johnson, JP Vonsattel, ED. Louis, JP Taylor, HL Paulson</p>	
2:45-3:00	<p>S3.17 Elucidating the Role of NKX2-5 Expression in Skeletal Muscle <u>JT Gladman</u>, RS Yadava, M Manadl, Q Yu, MS Mahadevan</p>	
3:00-3:15	<p>S3.18 Highly Frequent Expansion and Contraction Mutations Drive Somatic DNA Diversity at the Myotonic Dystrophy Type 1 Locus <u>C F Higham</u>, F Morales, C A Cobbold, D T Haydon, D G Monckton</p>	
3:15-3:30	<p>S3.19 Detection of Slipped-DNAs at the Trinucleotide Repeats of the Myotonic Dystrophy Type I Disease Locus in Patient Tissues <u>MM Axford</u>, Y Wang, M Nakamori, M Zannis-Hadjopoulos, CA. Thornton, C E Pearson</p>	
3:30-3:45	<p>S3.20 Combinatorial Mutagenesis of the ZF RNA-binding Domains of MBNL1 Elucidate Distinct Classes of Pre-mRNA Regulatory Events <u>J Purcell</u>, JC Oddo, JA Berglund</p>	
3:45-4:00	<p>S3.21 The RNA-binding Protein Staufen1 is Increased in DM1 Skeletal Muscle and Regulates Pre-mRNA Splicing <u>A Ravel-Chapuis</u>, G Bélanger, RS Yadava, MS Mahadevan, L DesGroseillers, J Côté, BJ Jasmin</p>	
4:00-4:15	<p>S3.22 Transcriptome Regulation by Mbns via Splicing and Non-splicing Mechanisms <u>ET Wang</u>, S Jog, M Biancollela, TT Wang, D Treacy, GP Schroth, DE Housman, S Reddy, CB Burge</p>	

IDMC-8 Scientific Program Continued

4:15-4:45	Coffee Break	Grand Ballroom
4:45-7:15	Session 4 – Cell and Animal Models for DM <i>Chairs: Geneviève Gourdon (Paris, France)</i> <i>Be Wieringa (Nijmegen, Netherlands)</i>	Island Ballroom
4:45-5:15	S4.1 Overview Lecture: Models of DM Disease Mario Gomes-Pereira (Paris, France)	
5:15-5:30	S4.23 A Novel RNA-binding Protein Suppresses Expanded CUG-induced Muscle Wasting <u>M de Haro</u> , I Al-Ramahi, KR Jones, J Holth, L Timchenko, J Botas	
5:30-5:45	S4.24 Muscle Weakness and T-Tubule Disorganization Induced by DM1-like Splicing Defects of Bin1 in Mice <u>AF Klein</u> , C Fugier, C Hammer, A Ferry, L Garcia, G Butler-Browne, N Charlet-Berguerand, D Furling	
5:45-6:00	S4.25 Cell and Tissue in Vivo Distribution of Foci: Assessing a Myotonic Dystrophy Biomarker <u>C. Dogan</u> , L. Revillod , G Gourdon , D Furling , J Puymirat , R-K Gherardi , G Bassez	
6:00-6:15	S4.26 Reduction of CUGBP1 in a RNA Toxicity Mouse Model has Beneficial Effects YK Kim, M Mandal, <u>MS Mahadevan</u>	
6:15-6:30	S4.27 Development of a Muscleblind-like 1 (MBNL1) Overexpression Model to Assess the Use of MBNL1 as a Potential Therapeutic for Myotonic Dystrophy <u>CM Chamberlain</u> , G Chen, T Ebner, LPW Ranum	
6:30-6:45	S4.28 Mbnl3/Mbl1 Loss has a Synergistic Effect in the Development of DM1 Skeletal Muscle Disease S Tring, K Personius, L Comai, <u>S Reddy</u>	
6:45-7:00	S4.29 Muscleblind-like 2 Knockout Mice: A Model for Splicing Alterations and Neurological Changes in the DM Brain K Charizanis, <u>K-Y Lee</u> , MM ScottI, G Xia, L Shiue, MS Cline, M Ares Jr, T Kimura, MP Takahashi, H Fujimura, K Jinnai, H Yoshikawa, MS Swanson	
7:00-7:15	S4.30 Early Transcriptional Changes and Developmental Abnormalities in a Zebrafish Model of Myotonic Dystrophy Type 1 <u>PK Todd</u> , F Ackall, J Hur, HL Paulson, JJ. Dowling	
Dinner (at a venue of your choice) & Relaxation Dinner for Science Subcommittees and Session Chairs at Columbia Restaurant (http://www.columbiarestaurant.com)		

IDMC-8 Scientific Program Continued

Friday, December 2, 2011		
7:00-5:00 PM	Information Desk Open	Prefuction Area of Ballroom
7:00-8:00	Breakfast	Grand Ballroom
8:00-12:30 PM	Session 5 – Clinical Features and Biomarkers Discovery <i>Chairs: Peter Harper (Cardiff, UK)</i> <i>Bjarne Udd (Tampere, Finland)</i>	Island Ballroom
8:00-8:30	S5.1 Overview Lecture: DM: Challenges of a Multisystemic Disease Benedikt Schoser (Munich, Germany)	
Invited Talks from Abstracts (10 min talk, 5 min question period)		
8:30-8:45	S5.31 Congenital Myotonic Dystrophy: Canadian Surveillance and Cohort Study <i>C Campbell, R Taranik, S Venance, V Siu, S Levin, P Jacob</i>	
8:45-9:00	S5.32 A Randomized Controllef Trial of Prophylactic Implantable Carbioverter-Defibrillators is Feasible in the Myotonic Dystrophy Type 1 Population <i>WJ Groh, C Shen, PM Pascuzzi</i>	
9:00-9:15	S5.33 Defining Health Related Quality of Life in Congenital and Juvenile Myotonic Dystrophy: The First Step in the Development of a Disease-Specific Instrument <i>N Johnson; E Luebbe; E Eastwood; N Chin, RT Moxley, III, C Heatwole</i>	
9:15-9:30	S5.34 Improved Survival by Cardiac Electrophysiologic Study-based Management of Myotonic Dystrophy Type 1 Associated with Overt Disease of the Conduction System <i>D Duboc, C Meune, R Porcher, H Marc Bécane, A Lazarus, P Laforêt, T Stojkovic, A Béhin, H Radvanyi-Hoffmann, B Eymard, K Wahbi</i>	
9:30-9:45	S5.35 Disease Burden in DM1: Results from a 278 Patient Cross Sectional Study <i>C Heatwole, R Bode, N Johnson, C Quinn, W Martens, M McDermott, N Rothrock, C Thornton, B Vickrey, D Victorson, R Moxley</i>	
9:45-10:00	S5.36 Multicenter French-Quebec Myotonic Dystrophy Registry: A Platform for Research and Clinical Trials <i>G Bassez, JP Bouchard, C Guiraud-Dogan, J Mathieu, D Hamroun, L Cossette, C Bérourd, members of the Canadian and French DM Networks, Bruno Eymard, Jack Puymirat</i>	
10:00-10:30	Coffee Break	Grand Ballroom
10:30-10:45	S5.37 Development and Validation of a Disease Severity Index in DM1 <i>C Gagnon, J Mathieu</i>	
10:45-11:00	S5.38 Splicing Biomarkers of Disease Severity in Myotonic Dystrophy Type 1 <i>M Nakamori, K Sobczak, S Welle, A Puwanant, R Tawil, RJ Osborne, K Eichinger, RT Moxley III, CA Thornton</i>	

IDMC-8 Scientific Program Continued

11:00-11:15	S5.39 Gene Expression Biomarkers of Disease Severity in Myotonic Dystrophy Type 1 Muscle <u>KA Hagerman</u> , M Nakamori, S Welle, K Eichinger, J Dekdebrun, RT Moxley III, CA Thornton	
11:15-11:30	S5.40 Predictors of Tumor Development in Patients with Myotonic Dystrophy <u>M Das</u> , L Letren, JE Hilbert, WB Martens, RT Moxley III, MH Greene, SM Gadalla	
11:30-11:45	S5.41 Ophthalmologic Findings in Mexican Patients with Myotonic Dystrophy Type 1 <u>P Barojas</u> , JJ Magaña, G Ortega, N Leyva, B Cisneros, O Hernández-Hernández, E Barojas	
11:45-12:00 PM	S5.42 DM2 Linked Myopathy Caused by Uninterrupted Short (CCTG)⁵⁵ Repeat Expansion in ZNF9 Gene <u>T Suominen</u> , LL Bachinski, O Raheem, H Haapasalo, W Kress, R Krahe, B Udd	
12:00-12:15	S5.43 Evaluation of the Pathogenicity of Short Repeat Expansions at the DM2 Gene Locus <u>H Ellrott</u> , B Neitzel, A Abicht, B Czermin, C Doerner, I Holt, L Timchenko, W Kress, B Schoser	
12:15-12:30	S5.44 Cancer Risk in Patients with Myotonic Dystrophy <i>SM Gadalla, M Lund, RM Pfeiffer, S Gørtz, CM Mueller, RT Moxley III, SY Kristinsson, M Björkholm, FM Shebl, JE Hilbert, O Landgren, J Wohlfahrt, M Melbye, MH Greene</i>	
12:30-3:00	Lunch & Poster Viewing with Presenters Clinical Features and Biomarkers P37-P58 The Brain P59-P63 <i>Chairs: Tiemo Grimm (Würzburg, Germany)</i> <i>Baziel van Engelen (Nijmegen, The Netherlands)</i> Therapeutic Development P64-P81 <i>Chairs: Bruno Eymard (Paris, France)</i> <i>Mark Rogers (Wales, UK)</i>	Grand Ballroom
3:00-5:30	Session 6 – The Brain in Myotonic Dystrophy <i>Chairs: Bruno Eymard (Paris, France)</i> <i>Mark Rogers (Wales, UK)</i>	Island Ballroom
3:00-3:30	S6.1 Overview Lecture: DM and the Central Nervous System John Day (Palo Alto, USA)	
Invited Talks from Abstracts (10 min talk, 5 min question period)		

IDMC-8 Scientific Program Continued

3:30-3:45	S6.45 Widespread White Matter Microstructural Abnormalities in Congenital-onset and Juvenile-onset Myotonic Dystrophy <i>J Wozniak, B Mueller, C Bell, R Muetzel, K Lim, J Day</i>	
3:45-4:00	S6.46 Cognitive Decline in Myotonic Dystrophy Type 1 (DM1) <i>S Winblad, C Lindberg, L Samuelsson, G Meola</i>	
4:00-4:15	S6.47 Neuroradiologic Findings in a Series of 10 Patients with Childhood-onset Form of DM1 <i>A Jacquette, H Lemaitre, N Angeard, B Eymard, S Whalen, I Desguerre, F Brunelle, M Zilbovicius, D Heron, N Boddaert</i>	
4:15-4:30	S6.48 Neurocognitive Impairment in Childhood DM1: What Did We Learn, What Could We Expect? <i>N. Angeard, A. Jacquette, M. Gargiulo, B. Eymard, D. Héron</i>	
4:30-4:45	S6.49 Muscleblind-like 1 Knockout Mice Reveal Novel Splicing Defects in the Myotonic Dystrophy Brain <i>T Kimura, K-Y Lee, K Suenaga, M Nakamori, Y Tatsumi, MP Takahashi, H Fujimura, K Jinnai, H Yoshikawa, H Du, M Ares, Jr., MS Swanson</i>	
4:45-5:00	S6.50 Expression and Post-Translational Modification of CELF Family Proteins in DM1 Brains with a Differential Mis-splicing of Tau Exon 10 <i>CM Dhaenens, ML Frandemiche, FJ Fernandez-Gomez, C Carpentier, H Tran, A Sistiaga, M Goicoechea, H Obriot, S Eddarkaoui, MH Gavaert, B Sablonnière, L Buée, S Schraen-Maschke, A Lopez de Munain, N Sergeant, ML Caillet-Boudin</i>	
6:00	Shuttle leaves from the Sheraton to the Dali	
6:30-10:00	Science and Art: Trip to the Salvador Dali Museum Visit and reception at the new Salvador Dali museum in St Petersburg	Dali Museum
Saturday, December 3, 2011		
7:00-6:00 PM	Information Desk Open	Prefuction Area of Ballroom
7:00-8:00	Breakfast	Grand Ballroom
8:00-12:30 PM	Session 7 – Therapeutic Development <i>Chairs: Jack Puymirat (Quebec, Canada) Charles Thornton (Rochester, USA)</i>	Island Ballroom
Invited Talks from Abstracts (10 min talk, 5 min question period)		
8:00-8:15	S7.51 Antisense Approaches for Myotonic Dystrophy <i>J Puymirat, G Doucet, G Gourdon, D Furling, G Bassez and all members of the DM French-Canadian Network</i>	

IDMC-8 Scientific Program Continued

8:15-8:30	S7.52 Body-wide Reversal of Myotonia and Rescue of Myopathy in a Transgenic Mouse Model of DM1 by RNase H-Active Antisense Oligonucleotides (ASOs) <u>TM Wheeler</u> , AJ Leger, SK Pandey, AR MacLeod, M Nakamori, SH Cheng, BM Wentworth, CF Bennett, CA Thornton	
8:30-8:45	S7.53 RNase H-Mediated Degradation of Toxic RNA in Myotonic Dystrophy Type 1 <u>JE Lee</u> , TA Cooper	
8:45-9:00	S7.54 Enhanced Sensitivity of Nuclear-retained RNA Transcripts for RNAase H Active Antisense Oligonucleotides (ASOs): An application for Myotonic Dystrophy Type 1 (DM1) Therapy <u>SK Pandey</u> , TM Wheeler, AJ Leger, SH Cheng, BM Wentworth, CA Thornton, CF Bennett, Art Macleod	
9:00-9:15	S7.55 Potential Therapeutic Agents for Treatment of Myotonic Dystrophy; Synthesis and Evaluation of Pentamidine Analogs <u>MJ Bodner</u> , L Coonrod, D Farnsworth, MM Haley, JA Berglund	
9:15-9:30	S7.56 Systemic Delivery of RNAi Hairpins as a Treatment for DM1 in the HSALR Transgenic Mouse E Stepniak-Konieczna, CA Stoltzman, J Wei, DR Bisset, E Finn, JM Allen, CA Thornton, <u>JR Chamberlain</u>	
9:30-9:45	S7.57 In Vivo Discovery of a Peptide that Prevents CUG RNA Hairpin Formation and Reverses RNA Toxicity in Myotonic Dystrophy Models A García-López, B Llamusi, M Orzáez, E Pérez-Payá, RD Artero, <u>A. López Castel</u>	
9:45-10:00	S7.58 Silencing of CUG Expansion RNA in Myotonic Dystrophy 1 Mouse Models Using Adeno-associated Virus <u>Z Gao</u> , KR Clark, TA Cooper	
10:00-10:30	Coffee Break	Grand Ballroom
10:30-10:45	S7.59 Truncated Muscleblind-like Factor 1 Rescue Several Mis-splicing Events in Myotonic Dystrophy H Tran, C Carpentier, CM Dhaenens, FJ Fernandez-Gomez, C Lemercier, S Eddarkaoui, R Caillierez, S Bégard, H Obriot, N Charlet-Berguerand, S Schraen-Maschke, N Deglon, M Colin, L Buée, D Furling, ML Caillet-Boudin, <u>N Sergeant</u>	
10:45-11:00	S7.60 Splicing of CUG Repeats in the DMPK 3' UTR Attenuates DM1 Pathology ET Wang, <u>TT Wang</u> , D Treacy, C Burge, D Housman	
11:00-11:15	S7.61 Systemic Delivery of Conjugated (CAG)_n Oligonucleotides to Treat DM1 <u>S Mulders</u> , W van den Broek, A González-Barriga, B Aguilera, J van de Giessen, R Verheul, B Wieringa, J van Deutekom, DG Wansink	
11:15-11:30	S7.62 Some Observations on Oligo-based Therapy for Myotonic Dystrophy <u>JD Brook</u> , TE Robinson, A, Ketley, X Li, S Arya, I Udosen, J Granados Riveron, D Furling, CJ Hayes	

IDMC-8 Scientific Program Continued

11:30-11:45	S7.63 Mechanistic Studies on the Use of Triplet Repeat Antisense Oligonucleotides in Myotonic Dystrophy <i>A González-Barriga, S Mulders, A Gudde, I van Kessel, W van den Broek, J van de Giessen, J van Deutekom, B Wieringa, DG Wansink</i>	
11:45-12:00	S7.64 Stabilization of Expanded (CTG)•(CAG) Repeats by Antisense Oligonucleotides <i>M Nakamori, G Gourdon, CA Thornton</i>	
12:00-2:00	Lunch	Grand Ballroom
2:00-6:00	Session 8 – Interactive Session <i>Chairs: Valerie Cwik (MDA)</i> <i>Darren Monckton (Glasgow, UK)</i>	
2:00-2:30	S8.1 Disease Mechanism Highlights <i>Mani Mahadevan (Charlottesville, USA)</i>	
2:30-3:00	S8.2 Clinical Science Highlights <i>Tee Ashizawa (Gainesville, USA)</i>	
3:00-3:30	S8.3 Therapy Highlights <i>Andrew Berglund (Eugene, USA)</i>	
3:30-4:30	S8.4 Questions from Patients and Families	
4:30-5:45	S8.5 Advocacy Group Presentations	
5:45-6:15	S8.6 IDMC and Steinert Award Presentations	
6:30-10:00	Farewell Gala Dinner on the Beach	Sheraton Sand Key Resort Beach

ABSTRACTS and POSTER DESCRIPTIONS

The Abstracts and Poster descriptions (pages 18 through 164)
have been removed from this document to honor confidentiality requirements

Attendee Contact Information

Aldehag, Anna

Karolinska University Hospital
Occupational Therapy Department
Stockholm,
171 76
Sweden
Tel: 4670 1671364
Email: anna.aldehag@karolinska.se

Angeard, Nathalie

Association Institut de myologie
47-83 Bd De L'hôpital
Hôpital de la Pitié-Salpêtrière
Batiment Babinski
Paris,
75013
France
Email: nathalie.angeard@parisdescartes.fr

Armstrong, Dustin

4s3 Bioscience
120 Wyllis Ave., #208
Everett, MA 02149
United States
Tel: (617) 462-3084
Email: dustin.armstrong@4s3bioscience.com

Arnold, W. David

Ohio State University
395 W. 12th Ave., Rm 722
Columbus, OH 43210
United States
Tel: (614) 787-7222
Fax: (614) 293-6111
Email: william.arnold@osumc.edu

Arya, Sukrat

The University Of Nottingham
Rm C14 Medical School
QMC
Nottingham,
NG7 2UH
United Kingdom
Email: plxsa6@nottingham.ac.uk

Ashizawa, Tetsuo

University Of Florida
Department of Neurology
100 S. Newll Dr.
Gainesville, FL 32611
United States
Tel: (352) 273-5550
Fax: (352) 273-5575
Email: tetsuo.ashizawa@neurology.ufl.edu

Axford, Michelle

University of Toronto
101 College St.
15-601E TMDT
Toronto, Ontario
M5G 1L7
Canada
Tel: (416) 813-8170
Email: michelle.axford@gmail.com

Ayhan, Fatma

University of Florida / Center for Neurogenetics
PO Box 103610
2033 Mowry Rd. Rm 225
Gainesville, FL 32610
Tel: (352) 273-5847
Fax: (352) 273-8284
Email: fayhan@ufl.edu

Attendee Contact Information

Bachinski, Linda

University of Texas M. D. Anderson Cancer Center
2614 Little Lake Ct.
Richmond, TX 77406
Tel: (713) 834-6346
Fax: (713) 792-1470
Email: lbachins@mdanderson.org

Bade, Diane

MDAmmdsgn
245 W. Leroy Ave.
Arcadia, CA 91007
United States
Tel: (626) 574-3647
Fax: (626) 821-6922
Email: diane.bade@methodisthospital.org

Banach, Marta

Instytut Psychiatrii i Neurologii
Sobieskiego 9
Instytut Psychiatrii i Neurologii
525 000 93 87
Warszawa,
02-957
Poland
Email: martabanach@yahoo.com

Bassez, Guillaume

Hopital Henri Mondor-Aphp
51 Ave. DE GéN.éral DE Lattre DE Tassigny
Creteil, creteil
94010
France
Tel: (0033) 14981211
Email: celine.dogan@hmn.aphp.fr

Batra, Ranjan

University of Florida
Box 100266
Gainesville, FL 32610
Tel: (352) 273-8155
Email: ranjan.18@ufl.edu

Behm-Ansmant, Isabelle

Laboratoire AREMS, UMR7214 CNRS-UHP
9 Avenue de la Forêt de Haye
Batiment Biopôle
BP70184
Vandoeuvre-Les-Nancy,
54506
France
Tel: (33) 3836855 ext: 31
Fax: (33) 3836855 ext: 09
Email: isabelle.behm@maem.uhp-nancy.fr

Belanger, Guy

University of Ottawa
CMM
451 Smyth Rd.
Ottawa, Ontario
J8Z3J8
Canada
Tel: (613) 562-5800 ext: 8030
Email: gbelange@uottawa.ca

Bennett, Frank

ISIS Pharmaceuticals
2855 Gazelle Ct.
Carlsbad, CA 92010
United States
Email: fbennett@isisph.com

Berglund, J.

University of Oregon
Institute of Molecular Biology
1229 University of Oregon
Eugene, OR 97403-1229
United States
Tel: (541) 346-5097
Email: aberglund@molbio.uoregon.edu

Attendee Contact Information

Bishop, Kathie

ISIS Pharmaceuticals, Inc
1896 Rutherford Rd.
Carlsbad, CA 92008
United States
Tel: (760) 603-4671
Fax: (760) 603-4653
Email: kbishop@isisph.com

Blonsky, Karla

Marigold Foundation
33 Gleneagles Terr.
Cochrane, Alberta
T4C 1W4
Canada
Tel: 1 (403) 9326598
Email: kblonsky@biobasix.com

Bodner, Micah

University of Oregon
Institute of Molecular Biology
1370 Franklin Blvd.
Eugene, OR 97401
Tel: (541) 525-6613
Email: mbodner1@gmail.com

Boström, Katrin

Department Of Health & Medical Services
öRebrocounty Council Sweden
VikingaväGen 9
öRebro,
703 65
Sweden
Tel: 46 19-6027402
Fax: 46 19-6027525
Email: katrin.bostrom@orebroll.se

Botas, Juan

Baylor College of Medicine
One Baylor Plaza
Mail Stop 225
Houston, TX 77030
United States
Tel: (713) 798-3569
Email: jbotas@bcm.edu

Botta, Annalisa

Tor Vergata University of Rome
Via Montpellier, 1
Rome,
00133
Italy
Tel: 39 067259 ext. 6078
Fax: 39 062042 ext. 7313
Email: botta@med.uniroma2.it

Bourlier, Claude

Email: bourlier.claude@gmail.com

Brook, David

University of Nottingham
School of Biology
Queen's Medical Centre
Nottingham, Nottinghamshire
NG7 2UH
United Kingdom
Tel: 44 (115) 8230345
Fax: 44 (115) 8230313
Email: david.brook@nottingham.ac.uk

Burge, Christopher

MIT
31 Ames St., 68-271A
Cambridge, MA 02142
Tel: (617) 258-5997
Fax: (617) 452-2936
Email: cburge@mit.edu

Attendee Contact Information

Butler-Browne, Gillian

Myology Institut
47, bld de l'hôpital
G.H. Pitié-Salpêtrière
Bâtiment Babinski
Paris,
75651
France
Tel: 33 1-42165708
Fax: 33 1-42165700
Email: gillian.butler-browne@upmc.fr

Caillet-Boudin, Marie-Laure

INSERM U837/ Team 1
INSERM U837/ 1- Batiment Biserte
Rue M. Polonovski
Lille Cedex,
59045
France
Tel: (33) 32062207
Email: marie-laure.caillet@inserm.fr

Caillet-Boudin, Marie-Laure

INSERM U837/ Team 1
INSERM U837/ 1- Batiment Biserte
Rue M. Polonovski
Lille Cedex,
59045
France
Tel: (33) 32062207
Email: marie-laure.caillet@inserm.fr

Campbell, Craig

London Health Sciences Centre
800 Commissioners Rd. E.
Pediatric Neurology B1-177
London, on, Canada, Ontario
N6A 4G5
Canada
Tel: (519) 619-0951
Email: craig.campbell@lhsc.on.ca

Cardani, Rosanna

Department Biomol Science And Biotechnol
University Of Milan
Via Celoria 26
Milan,
20133
Italy
Tel: 39 02-50314937
Fax: 39 02-50314932
Email: rosanna.cardani@guest.unimi.it

Chabot, Benoit

Université de Sherbrooke
3001, 12e Ave. Nord
Faculté de médecine et des sciences de la santé
Départ. de microbiologie et d'infectiologie
Sherbrooke, Quebec
J1h 5n4
Canada
Tel: (819) 564-5295
Fax: (819) 564-5392
Email: benoit.chabot@usherbrooke.ca

Chamberlain, Chris

University of Florida / Center for Neurogenetics
PO Box 103610
2033 Mowry Rd. Rm 225
Gainesville, FL 32610
United States
Tel: (352) 273-5188
Fax: (352) 273-8284
Email: chamb199@ufl.edu

Chamberlain, Joel

University of Washington
School of Medicine
Dept of Medicine/Med Genetics
K-236C HSB
Seattle, WA 98195
Tel: (206) 255-2095
Fax: (206) 616-8272
Email: jrcham@uw.edu

Attendee Contact Information

Charlet, Nicolas

Igbmc
Cerbm
1 Rue Laurent Fries
Illkirch, NA
67404
France
Tel: 33 (388) 653309
Fax: 33 (388) 653201
Email: ncharlet@igbmc.fr

Chartrand, Pascal

Université De Montréal
2900 Edouard-Montpetit
Montréal, Quebec
H3c 3j7
Canada
Tel: (514) 343-5684
Fax: (514) 343-2210
Email: p.chartrand@umontreal.ca

Cheng, Chialin

Massachusetts General Hospital
Harvard Medical School
Center for Human Genetic Research
Massachusetts General Hospital
185 Cambridge St.
Boston, MA 02114
United States
Tel: (781) 850-5322
Email: cheng@chgr.mgh.harvard.edu

Chouinard, Maud-Christine

Université du Québec à Chicoutimi
555, Boul. De L'université
Chicoutimi, QuéBec
G7h2b1
Canada
Tel: (418) 545-5011 ext. 5344
Fax: 418-5455012
Email: mcchouin@uqac.ca

Cleary, John

University of Florida / Center for Neurogenetics
PO Box 103610
2033 Mowry Rd. Rm 225
Gainesville, FL 32610
United States
Tel: (352) 273-5847
Fax: (352) 273-8284
Email: john.cleary@ufl.edu

Comai, Lucio

University of Southern California
2250 Alcazar St. CSC 264
Los Angeles, CA 90033
United States
Tel: (323) 442-3950
Fax: (323) 442-2764
Email: comai@usc.edu

Coonrod, Leslie

University of Oregon
Institute of Molecular Biology
1370 Franklin Blvd.
Eugene, OR 97401
United States
Tel: (541) 346-1576
Email: leslie@coonrod.org

Cooper, Tom

Baylor College of Medicine
Department of Pathology And Immunology
Baylor College of Medicine
One Baylor Plaza
Houston, TX 77030
United States
Email: tcooper@bcm.edu

Attendee Contact Information

Cossette, Louise

CHUQ
2705 Bd Laurier
Quebec, PQ
G1V 4G2
Canada
Tel: (418) 654-2186
Fax: (418) 654-2207
Email: louise.cossette@crchul.ulaval.ca

Cote, Jocelyn

University of Ottawa
451 Smyth Rd., Rm 3111A
Ottawa, Ontario
K1H 8M5
Canada
Tel: (613) 562-5800 ext: 8660
Email: jcote@uottawa.ca

Das, Maya

University Of Maryland
School Of Medicine
Department of Epidemiology and Public Health
660 W. Redwood St
Baltimore, MD 21201
United States
Tel: (608) 239-4167
Email: mdas@umaryland.edu

Day, John

Stanford University
Neurology Department Stanford School of Medicine
300 Pasteur Dr.
Boswell, A342
Stanford, CA 94305
United States
Tel: (650) 726-7522
Email: jwday@stanford.edu

de Haro, Maria

Baylor College of Medicine
One Baylor Plaza
Rm S942
Houston, TX 77030
United States
Tel: (713) 798-3569
Email: mh135822@bcm.edu

Desjardins, Patrick

University of Quebec in Chicoutimi
555, Blv De L'universite
Chicoutimi, QC
G7H2B1
Canada
Email: patrick.desjardins@uqac.ca

Dickson, Alexa

Colorado State University
1682 Campus Delivery
Fort Collins, CO 80523
United States
Tel: (970) 491-0788
Email: alexa.dickson@gmail.com

Disney, Matthew

Scripps Florida
492 Peacock Ln. N.
Jupiter, FL 33458
United States
Tel: (716) 380-7737
Email: disney@scripps.edu

Dogan, Celine

Hopital Henri Mondor-Aphp
51 Ave. DE GÉN.éral DE Lattre DE Tassigny
Creteil, FRANCE
94010
France
Tel: 00 (33) 14981211
Fax: (33) 49812733
Email: celine.dogan@hmn.aphp.fr

Attendee Contact Information

Doty, Noelle

University of Florida
Center for Neurogenetics
PO Box 103610
2033 Mowry Rd. Rm225
Gainesville, FL 32610
United States
Tel: (352) 273-5847
Fax: (352) 273-8284
Email: nmoncada@ufl.edu

Eichinger, Katy

University of Rochester Medical Center
601 Elmwood Ave.
PO Box 673
Rochester, NY 14642
United States
Tel: (585) 276-4030
Fax: (585) 273-1255
Email: karen_richards@urmc.rochester.edu

Ekström, Anne-Berit

University of Gothenburg
Department of Pediatrics
Pediatric Rehabilitation Centre
Martha Sennegårds väg 10 A
Gothenburg,
418 77
Sweden
Email: anne-berit.ekstrom@vgregion.se

Ellrott, Helena

Friedrich-Baur-Institute, Munich
Pognerstrasse 23
München,
81379
Germany
Email: helena.ellrott@med.uni-muenchen.de

Eymard, Bruno

Hôpital Pitié-Salpêtrière Institut De Myologie
47-83 Bd DE L'hôpital
Institut DE Myologie
Bâtiment Babinski
Paris,
75013
France
Tel: +33 (1) 42163713
Email: anne-marie.maronne@psl.aphp.fr

Fernandez Costa, Juan Manuel

University of Valencia
Departament de Genetica
Campus Burjassot Ed.B 6 planta, Burjassot (Valencia)
E46100
Spain
Tel: 34 (961) 625580
Email: j.manuel.fernandez@uv.es

Foff, Erin

University of Virginia Health System
UVA Neurology
PO Box 800394
Charlottesville, VA 22908
United States
Tel: (434) 924-9814
Fax: (434) 982-1726
Email: epf4b@virginia.edu

Freyermuth, Fernande

IGBMC
1 Rue Laurent Fries
Illkirch,
67404
France
Tel: 33 38865 ext. 3357
Fax: 33 38865 ext. 3201
Email: freyerfe@igbmc.fr

Furling, Denis

Um76 - Institut de Myologie
Email: denis.furling@upmc.fr

Attendee Contact Information

Furuya, Hirokazu

National Omuta Hospital, Fukuoka
Tachibana 1044-1
Omuta, Fukuoka
8370911

Japan

Tel: 81 (944) 581122

Fax: 81 (944) 586804

Email: furuya@neuro.med.kyushu-u.ac.jp

Gadalla, Shahinaz

National Institute of Health
6120 Executive Blvd., Rm 7019
Rockville, MD 20852
United States

Tel: (301) 435-4721

Fax: (301) 496-1854

Email: gadallas@mail.nih.gov

Gagnon, Cynthia

Université De Sherbrooke
Clinique Des Maladies Neuromusculaires
2230 DE L'hôpital Cp 1200
Jonquière, Québec
G7X 7X2
Canada

Tel: 1 (418) 6957777

Fax: 1 (418) 6957758

Email: cynthia.gagnon4@usherbrooke.ca

Gao, Zhihua

Baylor College of Medicine
1 Baylor Plaza
268B

Houston, TX 77030

United States

Tel: (713) 798-5021

Fax: (713) 798-5838

Email: zgao@bcm.edu

Geille, Alain

Email: alain.geille1@libertysurf.fr

Géraldine, Sicot

INSERM U781
62 Ave. Du Général Leclerc
Paris,
75014

France

Tel: 33 68281990 ext. 4

Email: sicot.geraldine@gmail.com

Gladman, Jordan

University of Virginia
415 Ln. Rd., 5 Building Rm 3226
Charlottesville, VA 22903
United States

Tel: (614) 284-7461

Email: jtj6e@virginia.edu

Gomes-Pereira, Mario

Inserm, Necker Hospital
Inserm U781
Necker Faculty of Medicine
156 Rue De Vaugirard

Paris,

75015

France

Tel: 33 1-40615334

Fax: 33 9-58616581

Email: mario.pereira@inserm.fr

Gonzalez, Anchel

Radboud University Nijmegen/ncmls
Geert Grooteplein 28
Nijmegen,
6525GA

Netherlands

Tel: 31 (62) 1673181

Email: a.gonzalez@ncmls.ru.nl

Goodwin, Marianne

University of Florida
Box 100266
Gainesville, FL 32610
United States

Tel: (352) 273-8155

Email: mariannegoodwin@ufl.edu

Attendee Contact Information

Gourdon, Genevieve

Inserm , Université Paris Descartes
156 Rue de Vaugirard
Paris,
75015
France
Tel: 33 1-40165334
Fax: 33 1-40615445
Email: genevieve.gourdon@inserm.fr

Greene, Mark

Clinical Genetics Branch, NCI
6120 Executive Blvd.
Room EPS 7032
Rockville, MD 20852
United States
Tel: (301) 594-7641
Fax: (301) 496-1854
Email: greenem@mail.nih.gov

Grimm, Tiemo

University Wuerzburg Germany
Am Hubland
Biozentrum
Wuerzburg,
97074
Germany
Tel: 49 (931) 3184076
Fax: 49 (931) 3184434
Email: tgrimm@biozentrum.uni-wuerzburg.de

Groh, William

Indiana University
5555 N. Delaware St.
Indianapolis, IN 46220
United States
Tel: (317) 962-0102
Email: wgroh@iupui.edu

Gudde, Anke

Department Cell Biology,
Nijmegen Centre for Mol. Life Sciences
Geert Grooteplein 26, 6525 GA
P.O Box 9101, 6500 HB
Nijmegen,
Netherlands
Tel: 31 (24) 3613664
Fax: 31 (24) 3615317
Email: a.gudde@ncmls.ru.nl

Hagerman, Katharine

University of Rochester
67 Lilac Dr. #1
Rochester, NY 14620
United States
Tel: (585) 275-4184
Email: katharine_hagerman@urmc.rochester.edu

Hagerman, Michael

DirectorsEdge Inc.
4756 Woodgreen Dr.
West Vancouver, BC
V7s2z6
Canada
Tel: (604) 838-9020
Email: michael.hagerman@directorsedge.com

Harati, Yadollah

Baylor College of Medicine
6550 Fannin, Ste. 1801
Houston, TX 77030
United States
Tel: (713) 798-5993
Fax: (713) 798-1486
Email: yharati@bcm.edu

Harper, Peter

Cardiff University
Email: HarperPS@cardiff.ac.uk

Attendee Contact Information

Hathorn, Tyisha

University of Florida
Center for Neurogenetics
PO Box 103610
2033 Mowry Rd. Rm 225
Gainesville, FL 32610
United States
Tel: (352) 273-5188
Fax: (352) 273-8284
Email: thathorn@ufl.edu

Hausknecht, Don

Retired
3909 Via Dolce
Marina del Rey, CA 90292
United States
Tel: (310) 306-4914
Fax: (310) 306-5014
Email: ucladon@verizon.net

Hébert, Luc

National Defence of Canada
56 rue Saint-Louis
Quebec, Quebec
G1R 3Z3
Canada
Tel: (418) 844-5000 ext: 5835
Fax:
Email: ljhebert@videotron.ca

Hernandez-Hernandez, Oscar

National Rehabilitation Institute
Av. Mexico Xochimilco 289
México, D.f.
14389
Mexico
Tel: 52 55 -59991000 ext. 14708
Fax:
Email: heroscar@gmail.com

Hietaharju, Aki

Tampere University Hospital
Maustekatu 18b
Tampere,
33710
Finland
Email: hietahar@kolumbus.fi

Higham, Catherine

University of Glasgow
University Ave.
Glasgow,
G12 8QQ
United Kingdom
Email: c.higham.1@research.gla.ac.uk

Hogrel, Jean-Yves

Institut de Myologie
GH Pitié-Salpêtrière
Paris Cedex 13,
75651
France
Tel: 33 1-42165880
Fax: 33 1-42165881
Email: jy.hogrel@institut-myologie.org

Hohjoh, Hirohiko

National Institute of Neuroscience, Ncnp
4-1-1 Ogawahigashi
Kodaira
Tokyo,
187-8502
Japan
Email: hohjohh@ncnp.go.jp

Howe, Sarah

Marigold Foundation
7515 Flint Rd. SE
Calgary, Alberta
T2H 1G3
Canada
Tel: 1 (403) 2554648
Fax: 1 (403) 2309243
Email: admin@marigoldfoundation.org

Attendee Contact Information

Hussain, Syed-Rehan

Nationwide Children's Hospital
Center for Gene Therapy, Res Institute
700 Children's Dr.
Columbus, OH 43205
United States
Tel: (614) 589-6848
Email: syed-rehan.hussain@nationwidechildrens.org

Iannaccone, Susan

UT Southwestern Medical Center
5323 Harry Hines Blvd.
Mail Code 9063
Dallas, TX 75390-9063
United States
Tel: (214) 456-5220
Fax: (214) 456-5210
Email: susan.iannaccone@utsouthwestern.edu

Ishiura, Shoichi

Life Science, Graduate School Arts & Science
The University of Tokyo
3-8-1 Komaba
Meguro-ku
Tokyo,
153-8902
Japan
Tel: 81 (3) 54546739
Fax: 81 (3) 54546739
Email: cishiura@mail.ecc.u-tokyo.ac.jp

Jacquette, Aurélie

Association Institut de myologie - génétique
47-83 Bd De L'hôpital
Batiment Babinski
Paris,
75013
France
Email: aurelia.jacquette@psl.aphp.fr

Jasmin, Bernard

University of Ottawa
451 Smyth Rd.
Faculty of Medicine
University of Ottawa
Ottawa, Ontario
K1H 8M5
Canada
Tel: (613) 562-5800 ext: 8383
Email: jasmin@uottawa.ca

Johnson, Nicholas

University of Rochester Department of Neurology
601 Elmwood Ave.
PO Box 673
Rochester, NY 14618
United States
Tel: (520) 784-3589
Email: nicholas_johnson@urmc.rochester.edu

Jones, Karlie

Baylor College Of Medicine
One Baylor Plaza
Houston, TX 77030
United States
Tel: (832) 360-3219
Email: krjones@bcm.edu

Kalsotra, Auinash

Baylor College of Medicine
One Baylor Plaza, #268B
Houston, TX 77030
United States
Tel: (713) 798-5021
Fax: (713) 798-5838
Email: kalsotra@bcm.edu

Karachunski, Peter

Paul & Sheila Wellstone Dystrophy Center
2101 SE 6th St., MMC 2641E
Minneapolis, MN 55455
United States
Tel: (612) 626-0822
Fax: (612) 625-8488
Email: karac001@umn.edu

Attendee Contact Information

Kelly, John

MDSG
Bennetts Cottage
Martin
Fordingbridge,
SP6 3LN
United Kingdom
Tel: (01725) 519233
Email: bennettscottage@gmail.com

Ketley, Ami

University Of Nottingham
Centre for Genetics and Genomics, C14
Queen's Medical Centre
Nottingham,
NG7 2UH
United Kingdom
Tel: 44 0115-8230314
Email: ami.ketley@nottingham.ac.uk

Kierkegaard, Marie

Karolinska University Hospital
Karolinska Institutet
Stallbacken 8
Lidingö,
18161
Sweden
Email: marie.kierkegaard@karolinska.se

Kino, Yoshihiro

Riken Brain Science Institute
Lab. for Structural Neuropathology
Riken Brain Science Institute
2-1 Hirosawa
Wako-shi, Saitama
351-0198
Japan
Email: kino@brain.riken.jp

Klein, Arnaud

Um76 - Institut de Myologie
47/83 Bld De L'hospital
G.H. Pitie Salpetriere, Bat. Babinski
Paris,
75013
France
Tel: 33 1-42165707
Fax: 33 1-42165700
Email: arnaud.klein@upmc.fr

Koebis, Michinori

Graduate School of Arts and Sciences,
The University of Tokyo
Department of Life Sciences
Komaba 3-8-1
Meguro-ku
Tokyo,
153-8902
Japan
Tel: 81 (3) 54546739 ext: 46739
Fax: 81 (3) 54546739 ext: 46739
Email: m.koebis@gmail.com

Kojic, Zorana

University of Florida
2033 Mowry Rd.
PO Box 100266
Gainesville, FL 32610
United States
Tel: (727) 967-3746
Email: zorana87@ufl.edu

Kokunai, Yosuke

Osaka University
2-2
Yamadaoka
Suita, Osaka,
Japan
Tel: 81 (6) 68793571
Fax: 81 (6) 68793579
Email: kokunai@neuro.med.osaka-u.ac.jp

Attendee Contact Information

Krahe, Ralf

University of Texas
MD Anderson Cancer Center
Department of Genetics, Unit 1010
1515 Holcombe Blvd.
Houston, TX 77030
United States
Tel: (713) 834-6345
Fax: (713) 834-6319
Email: rkrahe@mdanderson.org

Kress, Wolfram

University of Wuerzburg
Biozentrum, Am Hubland
Wuerzburg,
97074
Germany
Email: wkress@biozentrum.uni-wuerzburg.de

La Donna, Kori

The University of Western Ontario
79 Ambleside Dr.
London, Ontario
N6G 4M3
Canada
Tel: 1 (519) 8582764
Fax: (519) 663-3328
Email: kladonna@uwo.ca

Laberge, Luc

Université du Québec à Chicoutimi
1030 Rue Beaugard
Chicoutimi, Québec
G7H1N7
Canada
Tel: 418 547-2191 ext. 489
Fax: 418 542-2853
Email: luc.laberge@uqac.ca

Lee, Johanna

Baylor College of Medicine
1 Baylor Plaza 268B
Houston, TX 77030
United States
Tel: (713) 798-5021
Fax: (713) 798-5838
Email: jelee@bcm.edu

Lee, Kuang-Yung

University of Florida
Box 100266
Gainesville, FL 32610
Tel: (352) 273-8156
Email: kyle.kylee@ufl.edu

Leone, Mario

University of Quebec in Chicoutimi
555 Blv De L'universite
Chicoutimi, QC
G7h2b1
Canada
Email: mario.leone@uqac.ca

Li, Moyi

University of Florida
Box 100266
Gainesville, FL 32610
United States
Tel: (352) 273-8155
Email: limoyi@ufl.edu

Li, Xin

Medical School
Queen's Medical Centre
Rm C14
Nottingham,
NG7 2UH
United Kingdom
Email: plxx13@nottingham.ac.uk

Attendee Contact Information

Lindberg, Christopher

Sahlgrenska University Hospital

Department of Neurology

Gothenburg,

41345

Sweden

Email: christopher.lindberg@vgregion.se

López Castel, Arturo

Valentia Biopharma S.L.

Catedrático José Beltrán, 2

Paterna, Valencia

46980

Spain

Email: a.lopez@valentiabiopharma.com

Lord, Shannon

801 Mt. Paran Rd., NW

Atlanta, GA 30327

United States

Tel: (404) 252-5451

Fax: (404) 252-8356

Email: smlord@mindspring.com

Lusakowska, Anna

Medical University of Warsaw

Zwirki I Wigury 61

Warszawa,

02-091

Poland

Tel: 48 22-5992770

Fax: 48 22-5991857

Email: anna.lusakowska@wum.edu.pl

Lynn, Richard

Lynn Foundation -

9608 Barkston Ct.

Rockville, MD 20850

United States

Tel: (240) 678-5391

Email: rwlynn@verizon.net

Mackenzie, Donald

Marigold Foundation

7515 Flint Rd. SE

Calgary, Alberta

T2H 1G3

Canada

Tel: 1 (403) 2554648

Fax: 1 (403) 2309243

Email: admin@marigoldfoundation.org

MacLeod, Robert

ISIS Pharmaceuticals, Inc.

2855 Gazelle Ct.

Carlsbad, CA 92010

United States

Tel: (760) 603-4618

Email: rmacleod@isisph.com

Magaña, Jonathan

National Rehabilitation Institute

Av. Mexico Xochimilco 289

México, D.f.

14389

Mexico

Tel: 52 55-59991000 ext. 14708

Email: maganasm@hotmail.com

Mahadevan, Mani

University of Virginia

MR5 Building, Rm. 3226

415 Ln. Rd.

PO Box 800904

Charlottesville, VA 22908

United States

Tel: (434) 243-4816

Fax: (434) 924-1545

Email: mahadevan@virginia.edu

Manchanda, Mini

University of Florida

Box 100266

Gainesville, FL 32610

United States

Tel: (352) 273-8156

Email: m.manchanda@ufl.edu

Attendee Contact Information

Matsuura, Tohru

Okayama University
Grad School of Medicine, Dental & Pharmacy Science
2-5-1 Shikata-cho, Kita-ku
Okayama,
700-8558
Japan
Tel: 81 (86) 2357365
Fax: 81 (86) 2357368
Email: tohrum@cc.okayama-u.ac.jp

Meola, Giovanni

University of Milan
Ircs Policlinico San Donato
Piazza Xxv Aprile, 7
Milan -Italy,
20154
Italy
Tel: (39) 02290038
Fax: (39) 02290038
Email: giovanni.meola@unimi.it

Mohan, Apoorva

University of Florida
Box 100266
Gainesville, FL 32610
United States
Tel: (352) 273-8155
Email: apoorva@ufl.edu

Monckton, Darren

University of Glasgow
Davidson Building
Glasgow, Lanarkshire
G13 1ND
United Kingdom
Tel: 44 (141) 3306213
Email: darren.monckton@glasgow.ac.uk

Morales, Fernando

Universidad de Costa Rica
Instituto DE Investigaciones En Salud
San Pedro de Montes de Oca
San José,
Costa Rica
Tel: (506) 251-1328 9
Fax: (506) 251-1513 0
Email: fernando.moralesmontero@ucr.ac.cr

Moxley, Richard

The University of Rochester Medical Center
Department of Neurology
601 Elmwood Ave.
Rochester, NY 14642
United States
Tel: (585) 275-5006
Email: richard_moxley@urmc.rochester.edu

Mulders, Susan

Prosensa
Bredeweg 75b
Groesbeek, Gelderland
6562 DC
Netherlands
Email: s.mulders@prosensa.nl

Nakamori, Masayuki

University of Rochester Medical Center
601 Elmwood Ave.
PO Box Box 645
Rochester, NY 14642
United States
Tel: (585) 273-3158
Email: masayuki_nakamori@urmc.rochester.edu

Oana, Kosuke

Yonbancho, 9-8-708
Chiyoda-Ku, Tokyo
102-0081
Japan
Tel: 81 (3) 32214746
Email: oanakosuke@gmail.com

Attendee Contact Information

Ohsawa, Nakaaki

Aino Institute for Aging Reserach
3-9-25
Higashiohda
Ibaragi City
Ibaraki, Osaka
5670012
Japan
Tel: 81 (72) 6213745
Fax: 81 (72) 6277878
Email: ohsawa@aiar.aino.or.jp

Ohsawa, Natsumi

The University of Tokyo
3-8-1, Komaba
Meguro-ku
Tokyo,
153-8902
Japan
Tel: 03 (5454) 6773
Fax: 03 (5454) 6739
Email: n.mikan15@gmail.com

Pandey, Sanjay

ISIS Pharmaceuticals
55 Gazelle Ct.
Carlsbad, CA 92010
Tel: (760) 603-2361
Fax: (760) 603-2502
Email: spandey@isisph.com

Pandya, Shree

University of Rochester Medical Center
601 Elmwood Ave.
PO Box 673
Rochester, NY14642
Tel: (585) 275-1005
Fax: (585) 273-1255
Email: karen_richards@urmc.rochester.edu

Pearson, Christopher

The Hospital for Sick Children
101 College St. E. Tower, Ste. 15-312
Toronto, Ontario
M5G117
Canada
Tel: (416) 813-8980
Email: dianne.clare@sickkids.ca

Petitclerc, Émilie

Université de Sherbrooke
1038, Rue Melançon
Chicoutimi, Québec
G7H 1N9
Canada
Email: emilie.petitclerc@usherbrooke.ca

Phillips, Margaret

University of Nottingham
Graduate Medical School, Room 5048
The Royal Derby Hospital
Uttoxeter Rd.
Derby, Derbyshire
DE22 3DT
United Kingdom
Tel: 44 (1332) 724606
Fax: 44 (1332) 724611
Email: angela.beighton@nottingham.ac.uk

Plourde, Annie

Grimm - Jonquière
2230 Rue De L'hôpital
CRDP Le Parcours, 7e étage
Cmm-Grimm
Jonquière, Québec
G7X 7X2
Canada
Tel: (418) 695-7700 ext. 2790
Email: aplourde@uqac.ca

Attendee Contact Information

Porter, John

num

Rakocevic Stojanovic, Vidosava

School of Medicine, Clinic of Neurology Ucc
Dr Subotica 6
Smiljaniceva 4
Belgrade,
11000
Serbia
Tel: (3811) 13064230
Email: vidosava_r@yahoo.co.uk

Purcell, Jamie

University Of Oregon
745 Throne Dr., #317
Eugene, OR 97402
United States
Tel: (435) 881-1645
Email: jpurcell@molbio.uoregon.edu

Ranum, Laura

University of Florida
Center for Neurogenetics
PO Box 103610
2033 Mowry Rd., Rm 225
Gainesville, FL 32610
United States
Tel: (352) 294-5209
Fax: (352) 273-8284
Email: ranum@ufl.edu

Puymirat, Jack

CHUQ/CHUL, Unit of Human Génétique, RC 9300
2705 BD Laurier
Quebec, PQ
G1V4G2
Canada
Tel: (418) 654-2186
Fax: (418) 654-2207
Email: jack.puymirat@crchul.ulaval.ca

Rau, Frédérique

Institut De Myologie
68 Rue Du Blauberg
Sarreguemines,
57200
France
Tel: 0033 67108939
Email: frederique.rau@hotmail.fr

Raheem, Olayinka

Neuromuscular Research Unit
University of Tampere
Hallituskatu 25 B 36
Tampere, Tampere
33200
Finland
Tel: 358 44348065
Fax: 358 (3) 35518430
Email: olayinka.raheem@uta.fi

Ravel-Chapuis, Aymeric

University of Ottawa
Department of Cellular And Molecular Medicine
451 Smyth Rd.
Ottawa, ON
K1H 8M5
Canada
Tel: 1 (613) 5625800 ext: 8030
Email: aravelch@uottawa.ca

Attendee Contact Information

Reddy, Kaalak

University of Toronto
101 College St., TMDT
Rm 15-601
Toronto, Ontario
M5G 1H7
Canada
Tel: (416) 813-8170
Email: kaalak.reddy@utoronto.ca

Reddy, Sita

University of Southern California
Keck School of Medicine
2250 Alcazar St.
IGM-240
Los Angeles, CA 90033
Tel: (323) 442-2457
Fax: (323) 442-2764
Email: sitaredd@usc.edu

Rehman, Shagufta

University of Virginia
Department of Pathology
415 Lane Road, Bldg. MR5, Room 3226
Charlottesville, VA 22908
United States
Tel: (434) 924-9816
Fax: (434) 924-2151
Email: sr9zz@virginia.edu

Reid, Tammy

University of Florida / Center for Neurogenetics
PO Box 103610
2033 Mowry Rd., Rm 225
Gainesville, FL 32610
United States
Tel: (352) 273-5189
Fax: (352) 273-8284
Email: tammy.reid@ufl.edu

Renna, Laura

Department Biomol Science And Biotechnol
University Of Milan
Via Celoria 26
Milan,
20133
Italy
Tel: 39 02-50314943
Fax: 39 02-50314932
Email: laura.renna@guest.unimi.it

Repik, Gabrielle

University of Florida
Center for Neurogenetics
PO Box 103610
2033 Mowry Rd., Rm 225
Gainesville, FL 32610
United States
Tel: (352) 273-5847
Fax: (352) 273-8284
Email: grepik@ufl.edu

Rhodes, Jeremy

University of East Anglia
School of Biological Sciences
Norwich Research Park
Norwich,
NR4 7TJ
United Kingdom
Tel: 44 1603-592252
Fax: 44 1603-592250
Email: j.rhodes@uea.ac.uk

Richer, Louis

Université Du Québec à Chicoutimi
UQAC-DSS
555 Boul. De L'université
Chicoutimi, Québec
G7H 2B1
Canada
Tel: (418) 545-5011 ext. 5418
Fax: (418) 545-5012
Email: louis_richer@uqac.ca

Attendee Contact Information

Rivera, Berenice

National Rehabilitation Institute
13 Aldebaran Villas de Atlixco
Puebla, Puebla
72197
Mexico
Tel: 52 55-47525919
Email: bere.rivera.mercado@gmail.com

Rizzi, Francesca

University of Milan
via Celoria 26
Milan,
20133
Italy
Email: rizzifra86@hotmail.it

Rogers, Mark

Institute of Medical Genetics, Cardiff
4, Mitre Pl.
Llandaff
Cardiff, South Glamorgan
CF5 2EQ
United Kingdom
Tel: 44 (029) 20744058
Fax: 44 (029) 20748966
Email: basicallymark@hotmail.com

Sansone, Valeria

Department Neurology,
University Milan, IRCCS PSD
Via Morandi, 30
San Donato Milanese,
20097
Italy
Tel: 3902 52774347
Fax: 3902 5274717
Email: valeria.sansone@unimi.it

Schoser, Benedikt

Friedrich-Baur Institute, LMU Munich
Ludwig-Maximilians University Munich
Ziemssenstr. 1A
Munich,
D-80336
Germany
Tel: 0049 (89) 51607400
Fax: 0049 (89) 51607402
Email: bschoser@med.uni-muenchen.de

Scotti, Marina

University of Florida
Box 100266
Gainesville, FL 32610
United States
Tel: (352) 273-8156
Email: because@ufl.edu

Sellier, Chantal

IGBMC
1 Rue Laurent Fries
Illkirch,
67404
France
Tel: 33 38865 ext. 3357
Fax: 33 38865 ext. 3201
Email: sellier@igbmc.fr

Sergeant, Nicolas

Inserm U837-1
1, Place de Verdun
Lille,
59045
France
Tel: 33 (03) 20622071
Email: nicolas.sergeant@inserm.fr

Attendee Contact Information

Slean, Meghan

University Of Toronto
101 College St.
TMDT East Tower 15-601E
Toronto, Ontario
M5G 117
Canada
Tel: (416) 813-8170
Email: meghan.slean@utoronto.ca

Stenberg, Myrna

University of Florida
Box 100266
Gainesville, FL 32610
United States
Tel: (352) 273-8075
Email: mstenber@ufl.edu

Subramony, S.

University of Florida
College of Medicine
Mcknight Brain Institute
100 S. Newell Dr, Rm L3-100
Gainesville, FL 32610
United States
Tel: (352) 273-5550
Email: s.subramony@neurology.ufl.edu

Suominen, Tiina

University of Tampere
Biokatu 10
Finn-medi 3
Tampere,
33520
Finland
Email: tiina.suominen@uta.fi

Swanson, Maurice

University of Florida
Department of Molecular Genetics and Microbiology
Cancer Genetics Research Complex
2033 Mowry Rd.
Gainesville, FL 32610
Tel: (352) 273-8076
Fax: (352) 273-8284
Email: mswanson@ufl.edu

Takahashi, Masanori

Osaka University
D-4, 2-2 Yamadaoka
Suita, Osaka
565-0871
Japan
Tel: 81 (6) 68793571
Fax: 81 (6) 68793579
Email: mtakahas@neuro.med.osaka-u.ac.jp

Tang, Zhenzhi

University of Rochester
363 Quinby Rd.
Rochester, NY 14623
United States
Tel: (310) 689-6068
Email: tangzhenzhi@gmail.com

Thornton, Charles

University of Rochester Medical Center
601 Elmwood Ave., Box 645
Rochester, NY 14642
United States
Tel: (585) 275-2542
Fax: (585) 276-1126
Email: charles_thornton@urmc.rochester.edu

Attendee Contact Information

Timchenko, Lubov

Baylor College of Medicine
One Baylor Plaza
Baylor College of Medicine
Rm T424
Houston, TX 77030
Tel: (713) 798-6911
Fax: (713) 798-3142
Email: lubovt@bcm.tmc.edu

Todd, Peter

University of Michigan
4005 Bsrb
109 Zina Pitcher Pl.
Ann Arbor, MI 48109-2200
United States
Tel: (734) 615-5632
Fax: (734) 647-9777
Email: petertod@umich.edu

Tomé, Stéphanie

The Hospital For Sick Children
101 College St., E. Tower
Toronto, ON
M5G 1L7
Canada
Tel: (416) 813-8170
Fax: (416) 813-4931
Email: stephanie.tome@gmail.com

Udd, Bjarne

Tampere/helsinki Finland
Tays
Tampere,
33520
Finland
Email: bjarne.udd@netikka.fi

Umemoto, George

Fukuoka University
7-45-1 Nanakuma, Jonan-ku
Fukuoka,
814-0180
Japan
Tel: (81-92) 8011011
Fax: (81-92) 8011044
Email: george@minf.med.fukuoka-u.ac.jp

Venance, Shannon

University of Western Ontario
339 Windermere Rd.
University Hospital
London, Ontario
N6A 5A5
Canada
Email: shannon.venance@lhsc.on.ca

Voigt, Alexandria

University of Florida
Box 100266
Gainesville, FL 32610
Tel: (352) 273-8156
Email: akayevoigt@ufl.edu

Wagner, Stacey

University of Oregon
Institute of Molecular Biology
492 Helen St.
Eugene, OR 97404
Email: swagner@molbio.uoregon.edu

Wahl, Margaret

Muscular Dystrophy Association
3300 E. Sunrise Dr.
Tucson, AZ 85718
United States
Tel: (520) 529-5343
Email: mwahl@mdausa.org

Attendee Contact Information

Wang, Eric

Harvard-MIT Division of Health Sciences
and Technology
303 Broadway 2f
Cambridge, MA 02139
United States
Tel: (610) 217-7234
Email: et_wang@mit.edu

Wang, Thomas

MIT-Koch Institute
771 Somerville Ave., #2
Somerville, MA 02143
United States
Email: wang.thomas.t@gmail.com

Wang, Wenli

University of Rochester Medical Center
127 University Park
Rochester, NY 14620
United States
Tel: (585) 281-8293
Fax: (585) 276-1947
Email: wenli_wang@urmc.rochester.edu

Wansink, Derick

Department Cell Biology, Nijmegen Centre for
Molecular Life Sciences
Geert Grooteplein 26/28, 6525 GA
PO Box 9101, 6500 HB
Nijmegen,
Netherlands
Tel: 31 (24) 3613664
Fax: 31 (24) 3615317
Email: r.wansink@ncmls.ru.nl

Welch, Ellen

PTC Therapeutics
100 Corporate Ct.
South Plainfield, NJ 07080
United States
Email: ewelch@ptcbio.com

Wheeler, Thurman

University of Rochester Medical Center
601 Elmwood Aven, Box 645
Rochester, NY 14642
Tel: (585) 275-6177
Fax: (585) 276-1126
Email: thurman_wheeler@urmc.rochester.edu

Wieringa, Berend

Radboud University Nijmegen Medical Centre
Department Cell Biology
NCMLS 283 Radboud University
Geert Grooteplein 28
Radboud UNMC
POBox 9101 6500 HB, Nijmegen
6525GA
Netherlands
Tel: 31 (24) 3614329 ext: 4287
Fax: 31 (24) 3615317
Email: b.wieringa@ncmls.ru.nl

Wiggans, R.

310 Skyline Pky.
Athens, GA 30606
United States
Tel: (706) 540-1665
Fax: (706) 353-0497
Email: glen547@charter.net

Williams, David

Southeastern Surgical Assoc.
152 Thacher Shore Rd.
Yarmouthport, MA 02675
United States
Tel: (508) 280-7609
Email: davidr.williams@comcast.net

Williams, Gayle

152 Thacher Shore Rd.
Yarmouthport, MA 02675
United States
Tel: (508) 280-7601
Email: davidr.williams@comcast.net

Attendee Contact Information

Wilusz, Carol

Colorado State University
Department of Microbiology, Immunology
And Pathology, Mail Drop 1682
Fort Collins, CO 80523
United States
Tel: (970) 491-4919
Email: cwilusz@colostate.edu

Winblad, Stefan

Department of Psychology, Gothenburg University,
Sweden
Haraldsgatan 1 Box 500
Gothenburg,
405 30
Sweden
Email: stefan.winblad@psy.gu.se

Wirth, Ulrich

Friedrich-Baur-Institute, Munich
Beichstraße. 5
Munich,
Germany
Email: ulrich_wirth@gmx.net

Xia, Guangbin

University of Florida
College of Medicine, Dept. of Neurology
100 S. Newell Dr., L3-100
PO Box 100236
Gainesville, FL 32610-0236
United States
Tel: (352) 273-5550
Fax: (352) 273-5575
Email: guangbin.xia@neurology.ufl.edu

Yadava, Ramesh

University of Virginia
415 Ln. Rd.
MR5, Room 3226
Charlottesville, VA 22908
United States
Tel: (434) 924-9816
Fax: (434) 924-2151
Email: ry3b@virginia.edu

Yu, Jane

University of Virginia
Department of Pathology
415 Lane Road , MR5, Room 3226
Charlottesville, VA 22908
United States
Tel: (4349) 249816
Email: qy4m@virginia.edu

Zhao, Yimeng

The University of Tokyo
Komaba 3-8-1 Building3-120
Meguro-Ku, Tokyo
153-8902
Japan
Tel: 81 (3) 54544519
Email: ann925@gmail.com

Zu, Tao

University of Florida
Center for Neurogenetics
PO Box 103610
2033 Mowry Rd., Rm 225
Gainesville, FL 32610
United States
Tel: (352) 273-5847
Fax: (352) 273-8284
Email: taozu@ufl.edu

Thank you to our sponsors for helping make the IDMC-8 conference possible.



The Marigold Foundation
Creating Hope & Opportunity



Shea-Robert Sheahan Trust



Cover picture compliments of the St. Petersburg Clearwater CVB